

2006 ADAMS COUNTY NEBRASKA

PREPARED BY THE
DEPARTMENT OF ROADS
Traffic Engineering Division
Highway Safety Section

Rural County Road and
Rural Highway Accidents

- Fatal Accident
- Injury Accident
- Property Damage Only Accident
(Damages Over \$1000)
- Non-Reportable
(Damages Under \$1000)

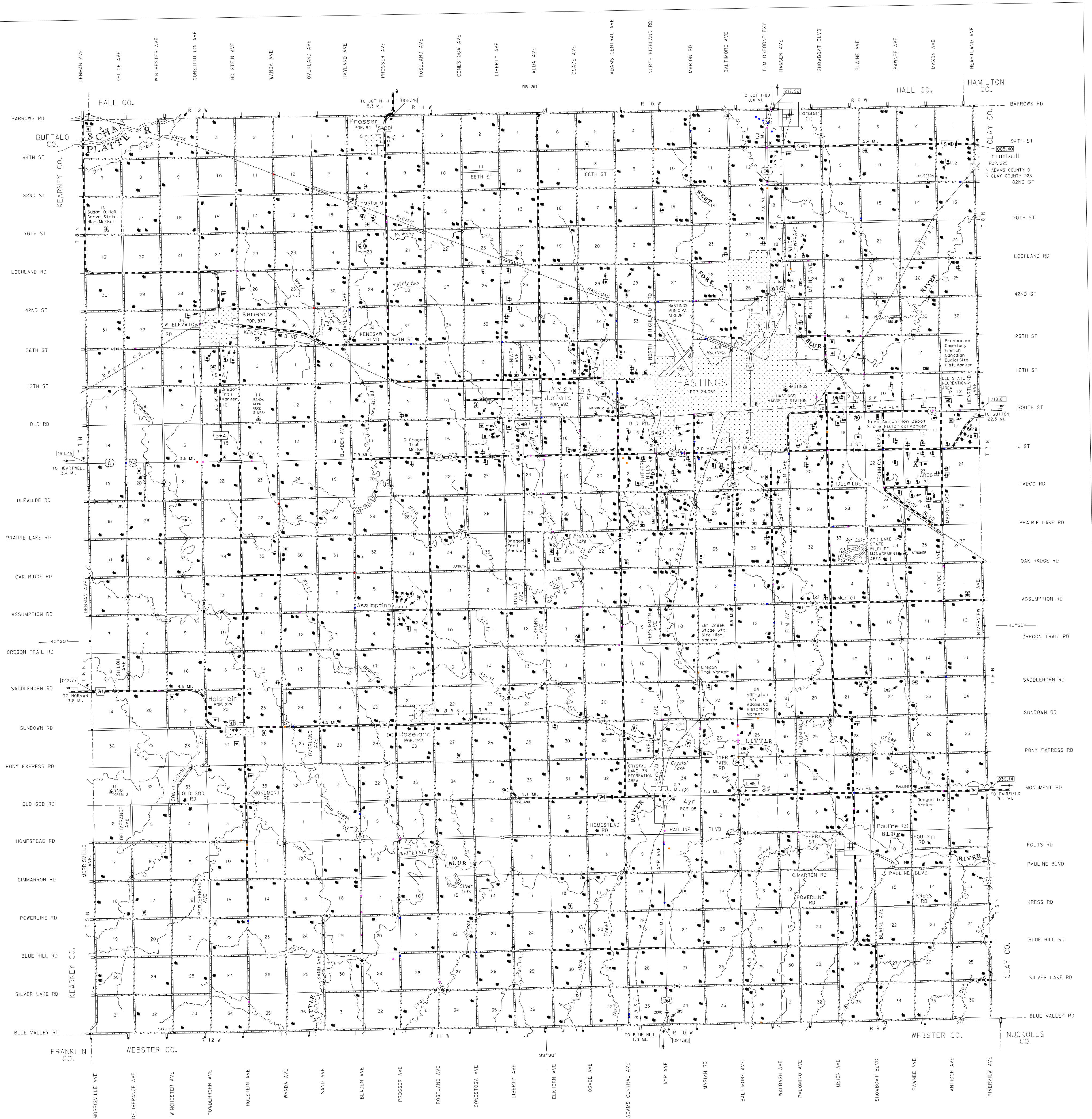
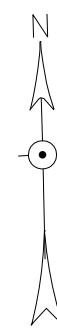
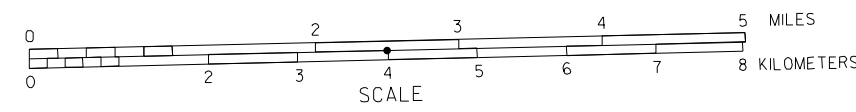

2006 ADAMS COUNTY NEBRASKA

PREPARED BY THE
DEPARTMENT OF ROADS
Traffic Engineering Division
Highway Safety Section

Rural County Road and
Rural Highway Accidents

- Fatal Accident
- Injury Accident
- Property Damage Only Accident
(Damages Over \$1000)
- Non-Reportable
(Damages Under \$1000)

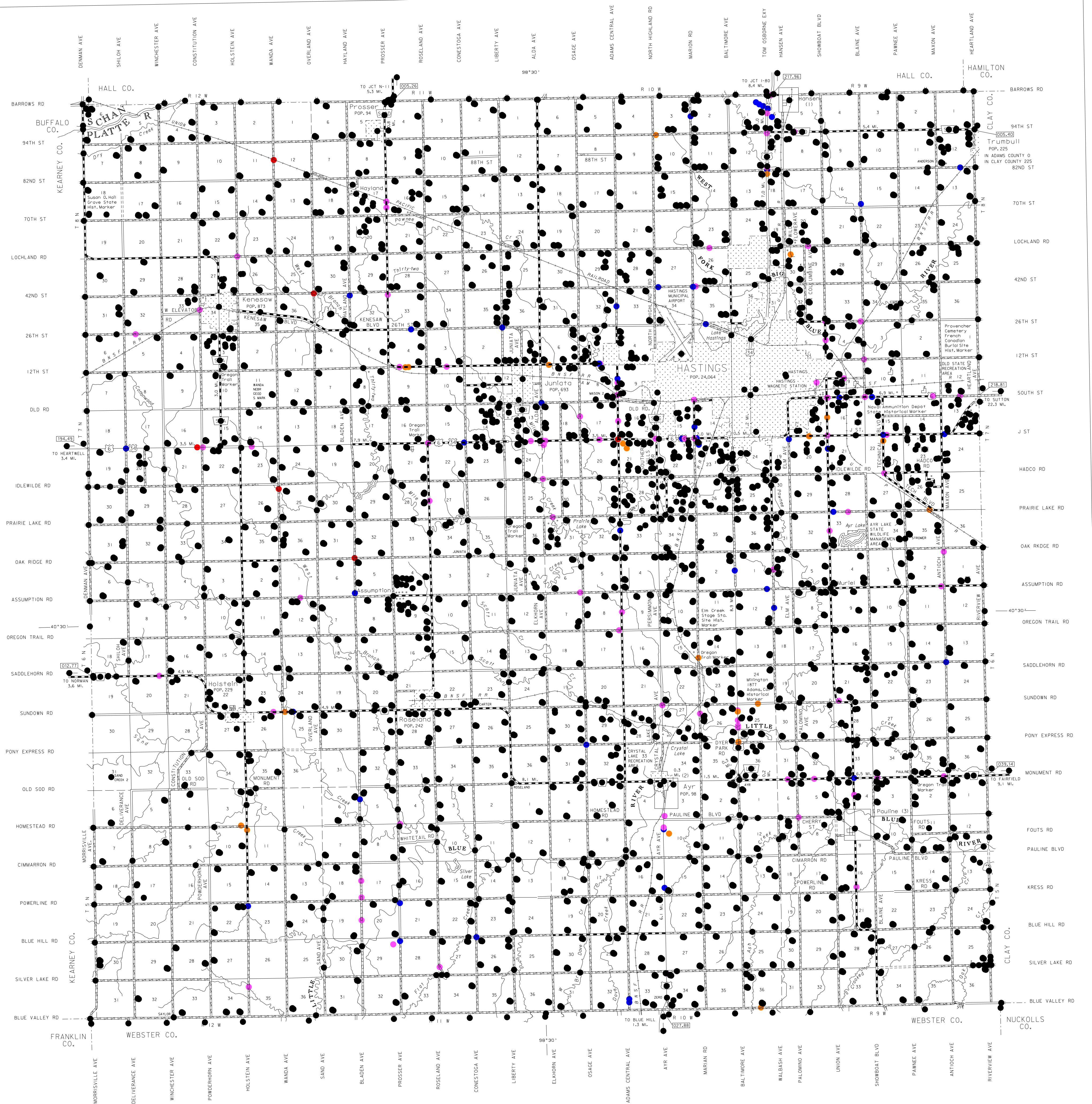
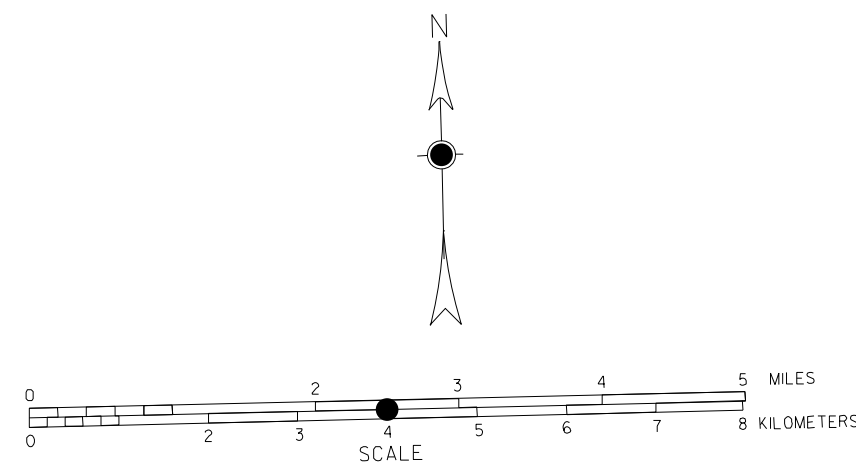

2006 ADAMS COUNTY NEBRASKA

PREPARED BY THE
DEPARTMENT OF ROADS
Traffic Engineering Division
Highway Safety Section

Rural County Road and
Rural Highway Accidents

- Fatal Accident
- Injury Accident
- Property Damage Only Accident
(Damages Over \$1000)
- Non-Reportable
(Damages Under \$1000)

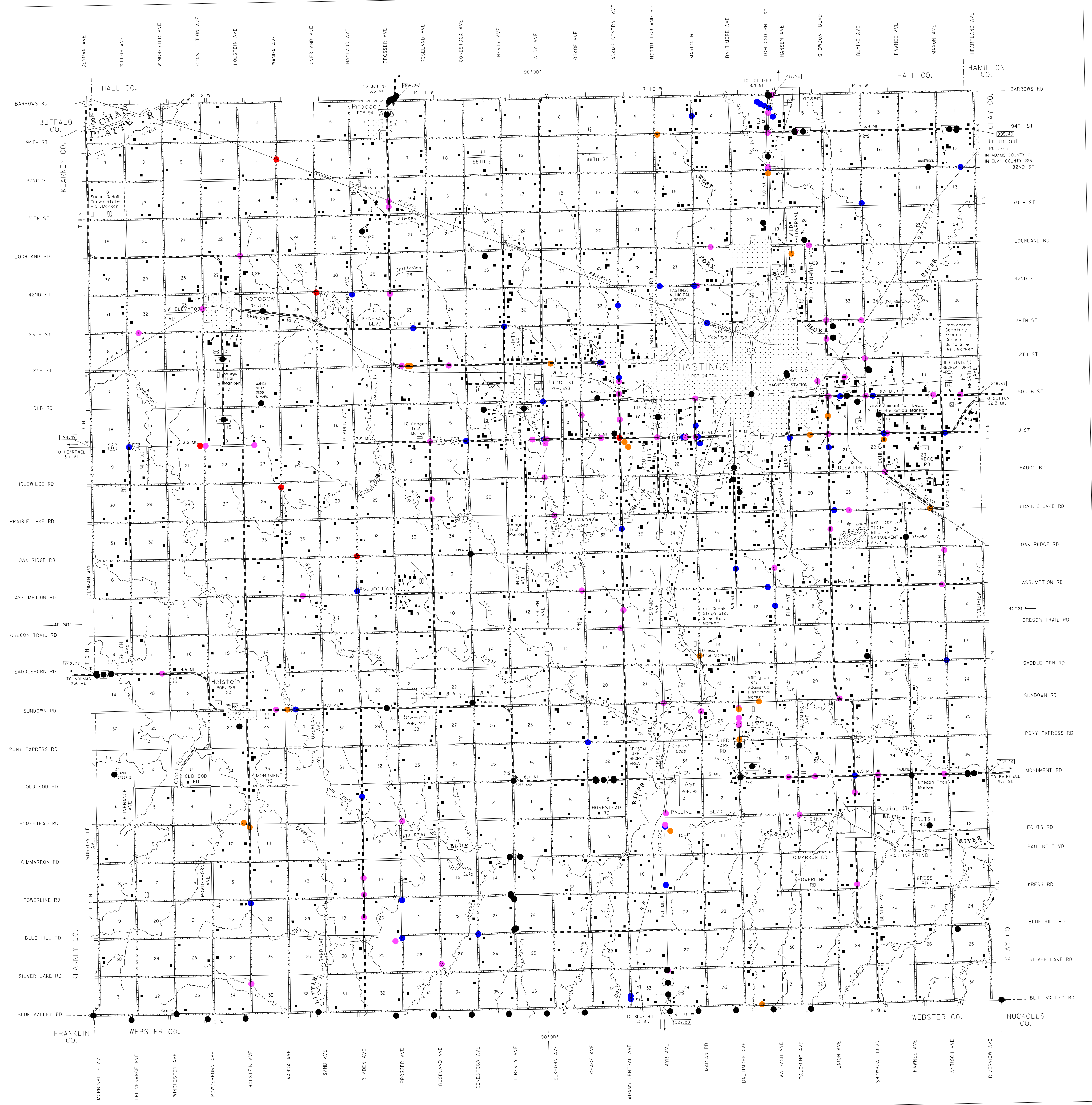
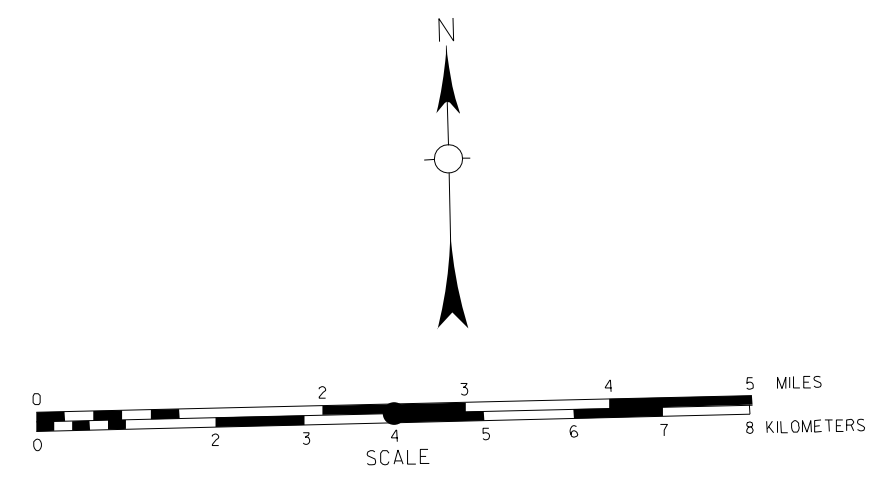

2006

ADAMS COUNTY NEBRASKA

PREPARED BY THE

DEPARTMENT OF ROADS

Traffic Engineering Division
Highway Safety Section

Rural County Road and Rural Highway Accidents

- Fatal Accident
- Injury Accident
- Property Damage Only Accident
(Damages Over \$1000)
- Non-Reportable
(Damages Under \$1000)

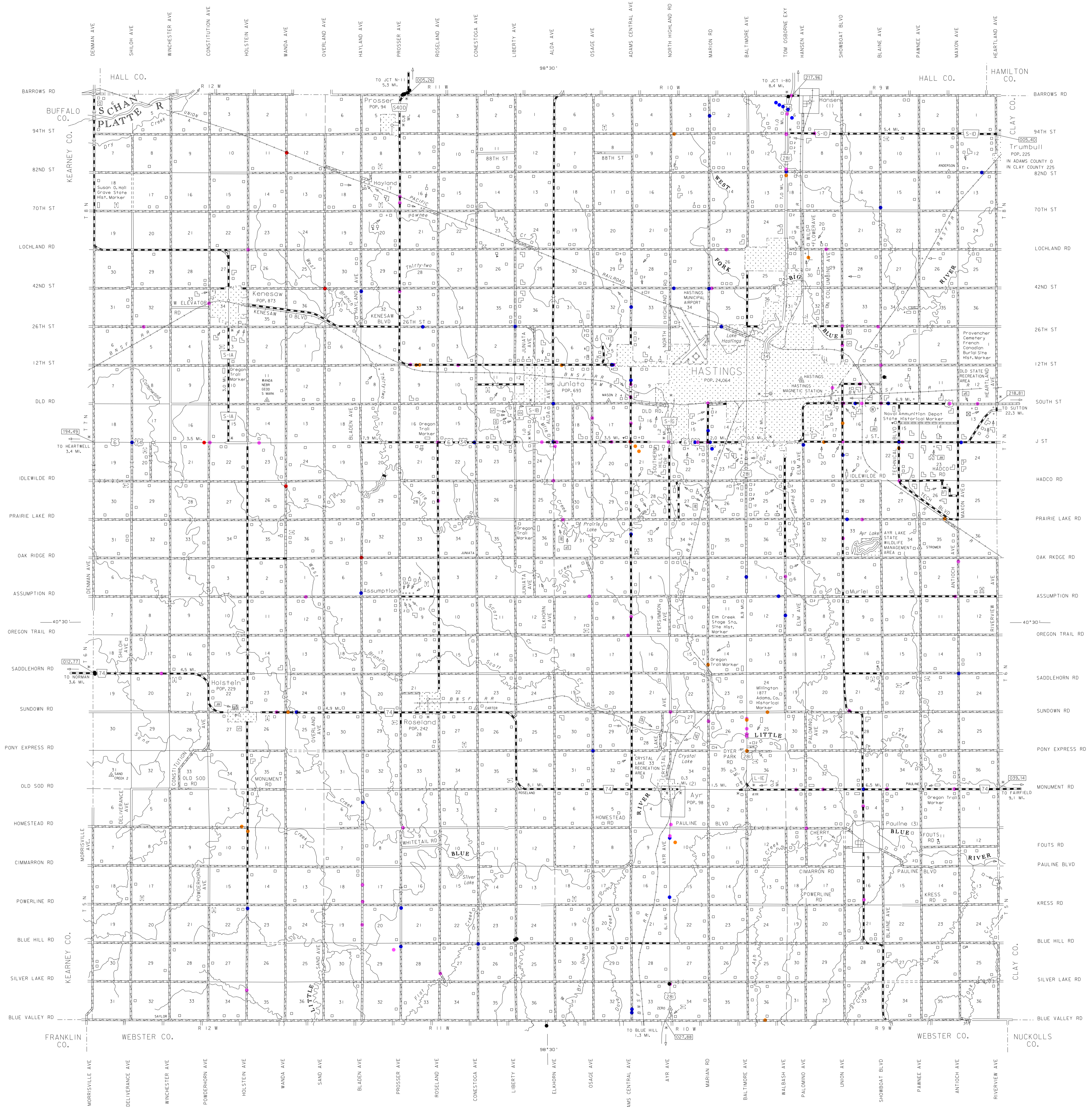
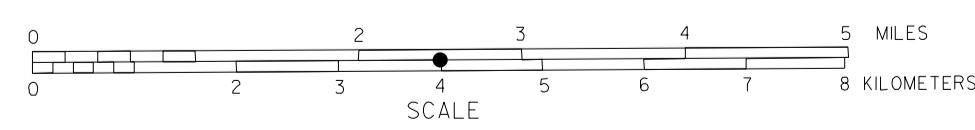
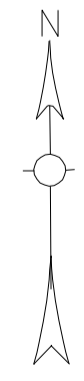

2006

ADAMS COUNTY NEBRASKA

PREPARED BY THE

DEPARTMENT OF ROADS

Traffic Engineering Division
Highway Safety Section

Rural County Road and Rural Highway Accidents

- Fatal Accident
- Injury Accident
- Property Damage Only Accident
(Damages Over \$1000)
- Non-Reportable
(Damages Under \$1000)

